

1ST CHOICE **EQUIPMENT** EXPERTS



CLIMATE CONTROL
EQUIPMENT SOLUTIONS

REICSPECIALTY.COM





DATA CENTER EQUIPMENT SOLUTIONS

RENTAL EQUIPMENT INSTALLATION, 24/7 SERVICE, & PREVENTATIVE MAINTENANCE

Budgeting for Active Projects & Estimating for Future Projects



APPLICATIONS

- Break Tent Conditioning & Personnel Cooling Stations
- Concrete Deck Heating & Curing
- Ground Thaw Applications
- Climatization for Interior Finishes
- Modular UPS Container Conditioning
- Admin Building Conditioning
- Data Hall Conditioning
- Central Utility Building Conditioning
- Mechanical Gallery Conditioning
- Protection Against Condensation in Electric Room, UPS, Switch Gear, etc.
- Dust/Airborne Particulate Mitigation, Air Scrubbing, & Positive/Negative Air Applications
- Remote Monitoring & Alarming (Minimum & Maximum Temperature & Humidity Thresholds)
- Commissioning Applications



HEATING SYSTEMS

SPECIFICATIONS

ELECTRIC HEATERS



1.5kW Heaters to 150kW Heaters
- 5,100 BTU/h - 512,000 BTU/h

MAKE-UP AIR HEATERS WITH GAS MODULATION



(LP / NG) 500,000 BTU/h - 4,500,000 BTU/h

INDIRECT-FIRED



(LP / NG / Diesel) 175,000 BTU/h - 2,000,000 BTU/h

SELF CONTAINED HEATERS



(Diesel) 1,000,000 BTU/h Trailer Mounted
w/ On-board 8kW Generator

FLAMELESS HEATERS



(Diesel) 500,000 BTU/h - 1,500,000 BTU/h

JETHEAT MICRO TURBINE HEATERS



(Diesel) 750,000 BTU/h - 1,500,000 BTU/h

GROUND THAW HEATERS



(Diesel) 360,000 BTU/h

RECESSED FLAME HEATERS



(LP / NG) 250,000 BTU/h - 1,100,000 BTU/h

COOLING SYSTEMS

SPECIFICATIONS

AIR COOLED



1ton / 1.25ton / 1.5ton / 2ton / 3ton / 5ton
- 12,000 BTU/h - 60,000 BTU/h

WATER COOLED



1.5ton / 3ton / 5ton
- 18,000 BTU/h - 60,000 BTU/h

DX ON CASTERS



5ton / 12ton
- 60,000 BTU/h - 144,000 BTU/h

SKID MOUNTED CONSTANT AIR VOLUME DX



5ton / 10ton / 25ton
- 60,000 BTU/h - 300,000 BTU/h

SKID MOUNTED HIGH STATIC DX W/ VFD



12ton / 25ton / 30ton / 40ton / 80ton
- 144,000 BTU/h - 960,000 BTU/h

DEHUMIDIFICATION

DESICCANT DEHUMIDIFIERS

LOW GRAIN REFRIGERANT DEHUMIDIFIERS



SPECIFICATIONS

15gpd - 30gpd

ELECTRIC DESICCANT DEHUMIDIFIERS



385CFM - 15,000CFM

TRI-FUEL DESICCANT DEHUMIDIFIERS



(LP / NG / Electric)
2,000CFM - 15,000CFM

INDOOR AIR QUALITY

NEGATIVE AIR MACHINES & AIR SCRUBBERS

NEGATIVE AIR MACHINES



SPECIFICATIONS

Three-Stage 99.97% HEPA Filtration
500CFM - 2,000CFM

HIGH VOLUME & HIGH VELOCITY AIR MOVERS



5,000CFM - 12,000CFM

DESIGN

Accuracy and Precision:
Highly accurate and precise design drawings

Enhanced Collaboration:
Our comprehensive design packages provide seamless collaboration amongst trades.

Documentation:
All-encompassing documentation that includes logistical information, equipment specifications, and installation guidelines.

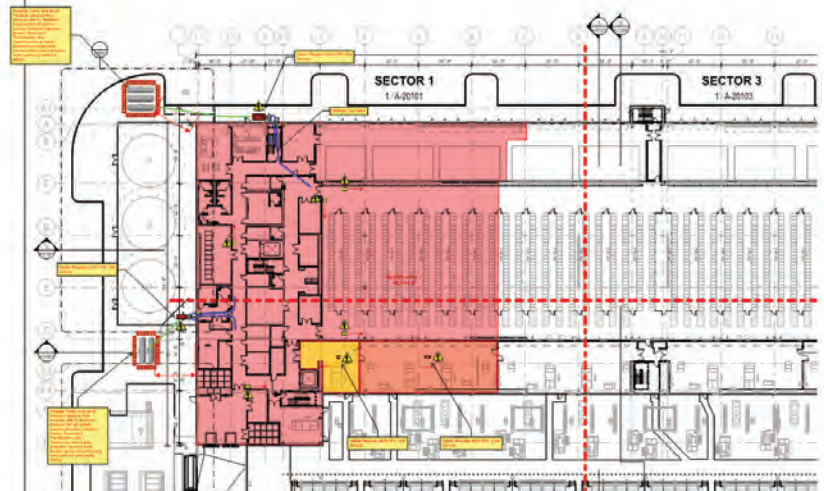

INSTALLATION & SERVICE

24/7/365 Customer Service:
Ensuring Uninterrupted Support for Your Equipment Needs

- Trained HVAC Installers & Technicians
- Round-the-Clock Availability
- Expert Assistance
- Rapid Response
- Flexible Solutions
- Emergency Support
- Convenient Communication Channels
- Reliability
- Peace of Mind



REMOTE MONITORING SYSTEMS

REAL-TIME DATA ACCESS & REPORTS:

Create reports and have access to real-time data on temperature and humidity levels, allowing for immediate detection of any deviations from set parameters.

IMPROVED EFFICIENCY:

Automating the monitoring process, reduces the need for manual checks, saving time and labor costs

DATA LOGGING AND ANALYSIS:

Store historical data, enabling trend analysis

ALERTS, NOTIFICATIONS & ALARMING:

Send alerts via SMS, Email, or App notifications if conditions fall outside of acceptable ranges

COST SAVINGS:

Prevent damage to sensitive products, materials, or equipment due to improper temperature or humidity levels.

REMOTE ACCESS:

Users can access data from anywhere, providing flexibility and convenience.

PREVENTIVE MAINTENANCE:

Continuous monitoring can help identify potential issues before they become major problems, allowing for proactive maintenance and reducing downtime.

CONTROL:

Maintain optimal temperature and humidity and ensure that these conditions are consistently met

**Remote Monitoring Devices
Temperature & Relative
Humidity Tracking**

